

User Instruction Manual



Contents

| | |
|-------------------------------------|----|
| Getting Started | 03 |
| What Is Infalurt? | 04 |
| How it Works | 06 |
| Setting Up Your Infalurt System | |
| — Preparation & Installation | 08 |
| — How to Cancel the Alarm | 13 |
| — Pairing Multiple Child Seat Units | 14 |
| — Flat Battery Notification | 15 |
| Frequently Asked Questions | 16 |
| Contact | 18 |



Getting Started

What you'll find in this pack



1 x

Child Seat Unit

(With hook & loop tape to rear)



1 x

Child Sensor Pad



1 x

Control Unit



1 x

Key Fob

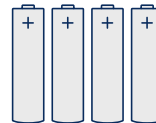

4 x

AA Batteries

Pre-installed in each unit



CR123 Battery

Pre-installed in Key Fob



1 x

Rear Windscreen
Decal

What is Infalurt?

Infalurt – the new child car seat alert system that could save lives.



 infalurt.

Infalurt technology has three simple components: a sensor that sits beneath the child seat, a control unit placed in an accessible position to the driver and a key fob alarm.

The system communicates to alert you if the child is left behind in the car once you leave the vehicle.

You can rest assured, knowing you are safeguarding against accidental and avoidable caregiver-child separations.

To learn more or watch our instruction video, please visit our website or YouTube channel.

→ infalurt.com.au

Key Benefits

It's the unfortunate reality that accidentally leaving children in cars while unattended is more common than you may think. Infalurt is the innovative device that is helping to tackle this problem, giving parents and caregivers much needed peace of mind.



Peace of mind
at all times



Key fob alarm
works with up to four
child seat sensors



Easy to set
up and use



Works with
leading child
car seat brands



Patent Pending
Design



100% Australian
Innovation



How it Works

This simple three component device works as an alarm system, alerting you if your child is left behind when you leave the vehicle.

1

Each unit is positioned in the car (see **Setting Up Your Infalurt System** on page 08). The system is primed when a child is detected by the sensor pad.

2

Once your child is in the seat, your Key Fob will start flashing blue approximately every 3 to 4 seconds.

3

If your child is left in the car and you've walked approximately 10m away from the vehicle, the Key Fob will generate a warning tone to warn you of your child being left behind. If you continue to walk away, the Key Fob activates a sounding alarm. If you return to within 10m of your vehicle, the Key Fob will deactivate the sounding alarm.

4

The Key Fob alarm continues until you press the button once, to mute (or snooze) alarm.

5

If you have not returned to your vehicle after a few seconds, the Key Fob will re-activate the alarm. The alarm will continue until you cancel it. See page 13 for how it works.

How it Works

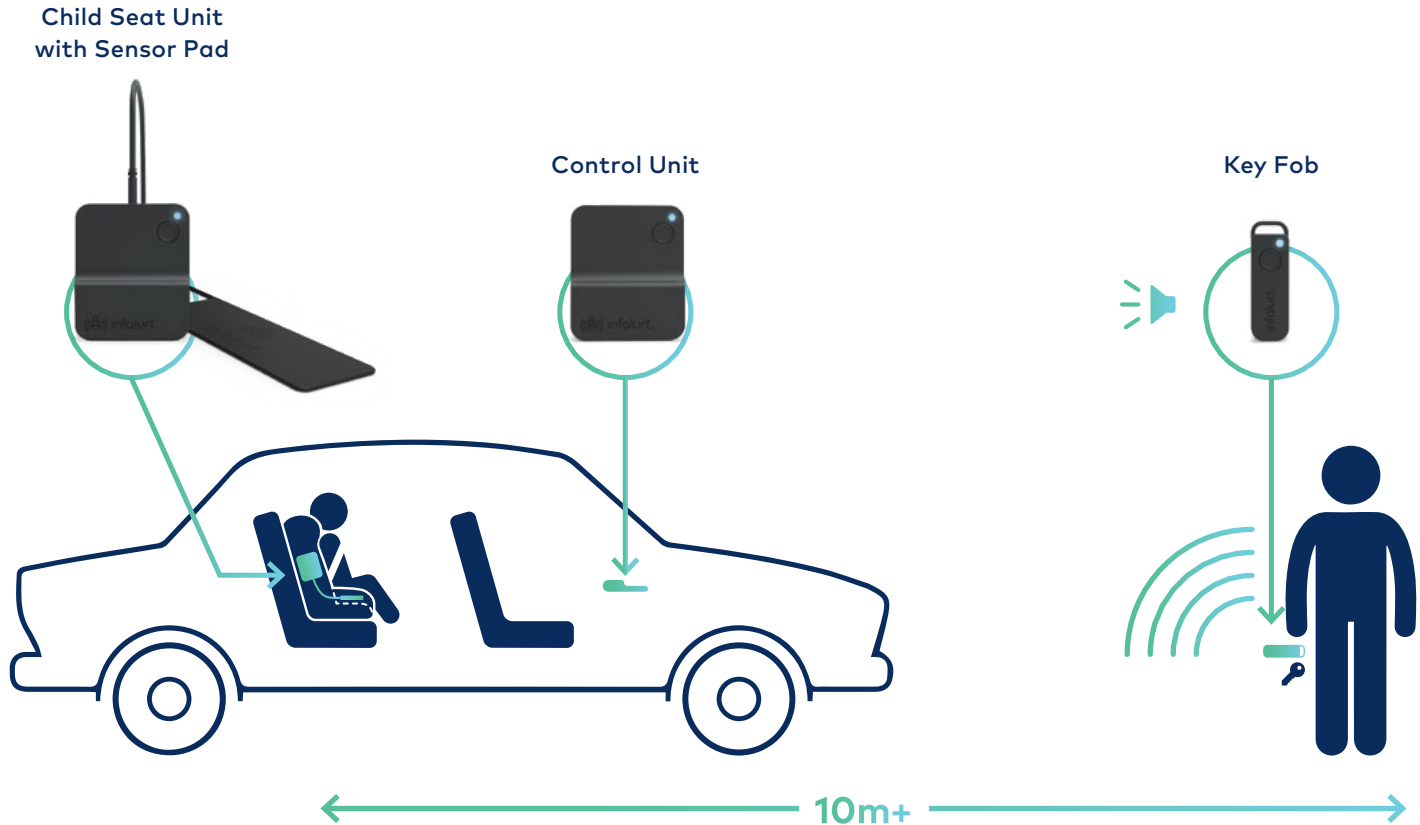

Setting Up Your Infalurt System

1 Battery Set Up

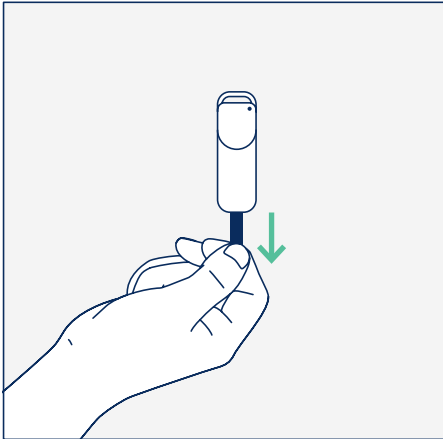

1. Pull out the plastic tab from the Key Fob, Control Unit, and Child Seat Unit to activate the battery. Clip plastic edges together where required.

2 Installing Infalurt in your Vehicle

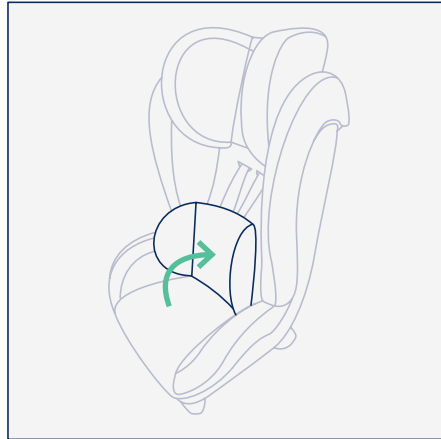

2a. Lift up the child seat factory cushion insert and keep it raised.

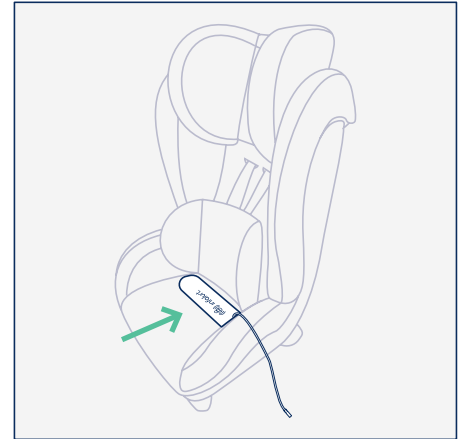

2b. Place Child Sensor Pad under your child seat factory cushion insert.

Setting Up Your Infalurt System

09

2 Installing Infalurt in your Vehicle

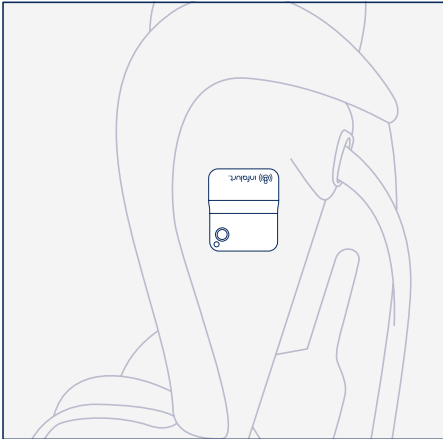

2c.

Place Child Seat Unit on side of the child seat in a suitable position with hook and loop tape provided.

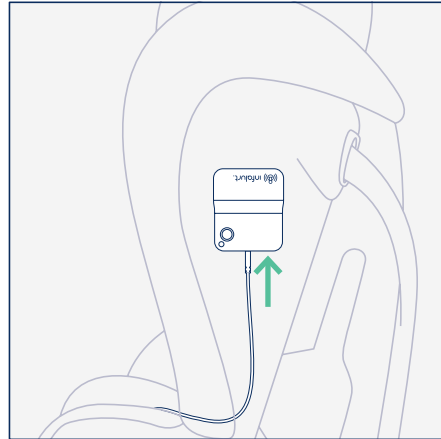

2d.

Plug Child Sensor Pad jack into Child Seat Unit (Red Light will stop flashing) and return Cushion Insert to downward position. To avoid tangling and/or view of cable, feed sensor cable through fabric or plastic via the seatbelt strap opening or armrest (dependent on child seat design).

⚠ Note: Ensure placement of Child Sensor Unit does not obstruct any child seat instructions or warning labels. If your child seat model does not have a cushion insert, we advise placing a lightweight tea towel over the sensor pad.

Setting Up Your Infalurt System

2 Installing Infalurt in your Vehicle

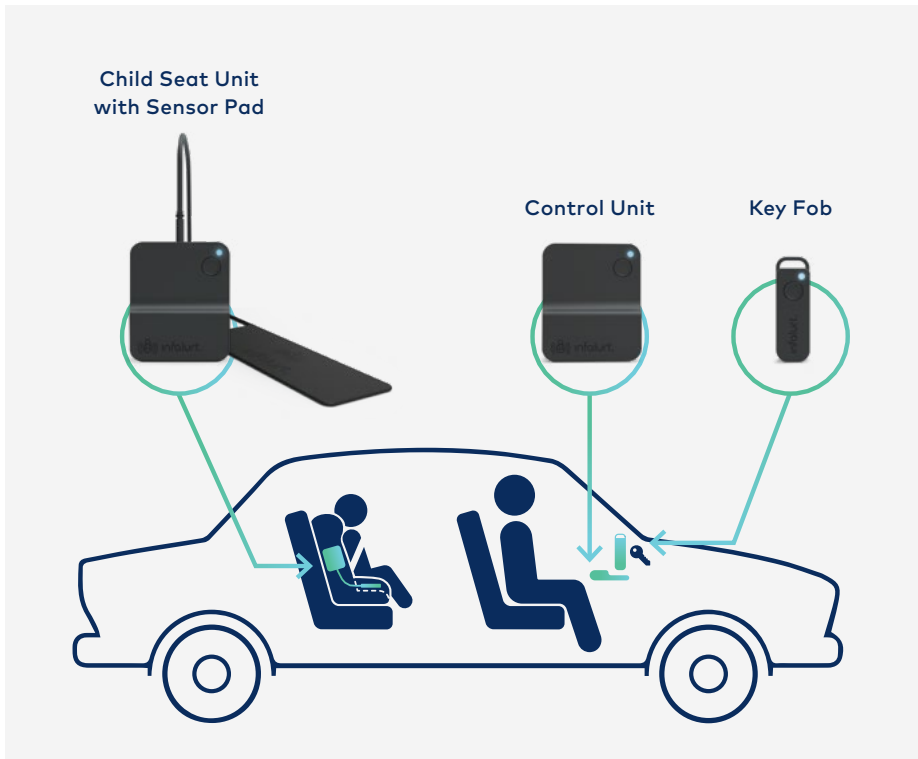

3 Pairing the System

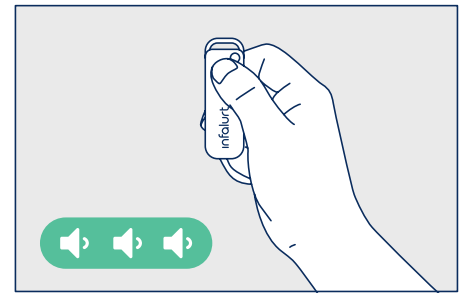

3a.

Press and hold Fob button down until you hear 3 beeps, then release.

Note:

If the Key Fob only flashes once or twice consecutively, one of the Units has not paired. Repeat Step 3a. to Step 3c. until the Key Fob flashes 3 times, to ensure successful pairing.

Setting Up Your Infalurt System

3 Pairing the System

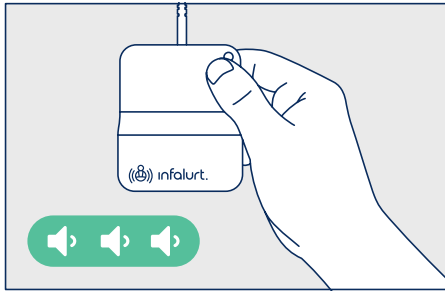

3b. Press and hold Child Seat Unit button down until you hear 3 beeps, then release.

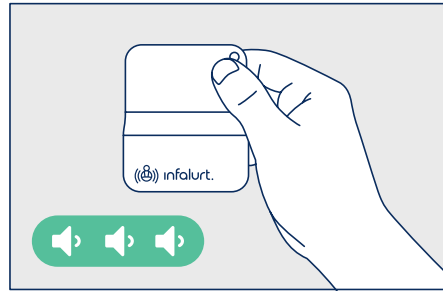

3c. Press and hold Control Unit button down until you hear 3 beeps, then release.

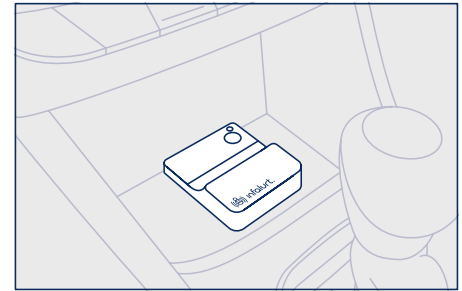

3d. Once paired, place Control Unit in your central console which is the optimal location (the Control Unit is the unit WITHOUT tape to rear).

✔ If successful

The blue light on your Child Sensor Unit and Control Unit should now be flashing and both Units emitting a regular single tone beep. The Key Fob should now be flashing 3 times consecutively, which means the pairing has been successful. Please allow beeping to finish prior to commencing Step 4 - Calibrating the System.

Setting Up Your Infalurt System

4 Calibrating the system

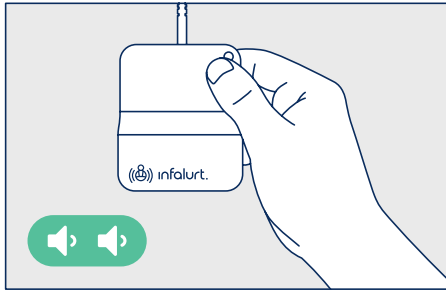

4a.
Press and hold Child Seat Unit button until you hear 2 beeps.

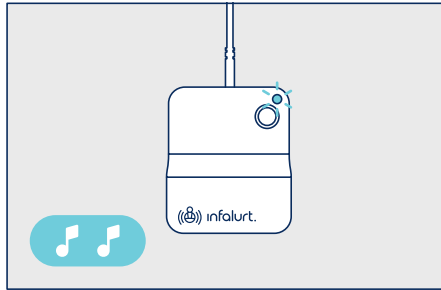

4b.
A few seconds later your unit will flash blue twice and emit 2 tones which means that your system is now calibrated and ready for use.

⚠ Note:

If the Child Seat Unit **flashes red** and emits 3 tones, please ensure that the Child Sensor Pad's cable is firmly connected to the Child Seat Unit and try again.

⚠ Note:

If you decide to relocate your Infalurt system to another child seat, you will need to calibrate the system to the new seat.



WARNING
We strongly recommend a test run prior to first use under supervised, controlled conditions.



How to Cancel Alarm

If your child is left in the car, the alarm on your key fob will activate when you're approximately 10m away. This alarm will continue until you cancel it.

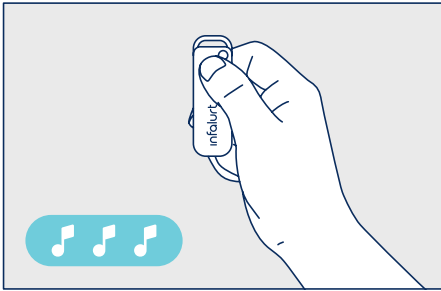

If you want to cancel the Key Fob alarm, hold down the Key Fob button until you hear 3 tones, and then release. This will cancel the alarm and will **NOT** re-activate if your child is still in the vehicle.

⚠ Note:

As an added safety feature, upon returning to the vehicle and reaching the 10m proximity zone, the Key Fob will re-arm itself and start flashing as a reminder that the child is still in the car.

10m refers to a straight line of sight with no solid obstacles in between the vehicle and Key Fob. If for example, there is a solid wall between the Key Fob and vehicle, the zone distance will be reduced and the Key Fob will activate sooner.



WARNING

Although you have the Infalurt system in your vehicle, please always check the backseat, and never leave children unattended in a vehicle.

Pairing Multiple Child Seat Units

Please repeat the instructions in **Steps 3a to 3b – Pairing the System** on page 11 for pairing of each additional Child Seat Unit.

The pairing has been successful when the blue light is flashing on the Child Sensor Unit and Control Unit.

The Key Fob should also be flashing the correct number of times as displayed in the table (right).

| No. of Units | No. of Key Fob Flashes |
|--------------------|-----------------------------------|
| 2 Child Seat Units | Key Fob will flash 4 times |
| 3 Child Seat Units | Key Fob will flash 5 times |
| 4 Child Seat Units | Key Fob will flash 6 times |

Note:

If the Key Fob flashes for less than the number of Units in the Vehicle as per above, one of the Units has not paired. If so repeat **Step 3 – Pairing the System**, until the Key Fob flashes to the required amount above.

Flat Battery Notification

Notification of a flat battery in any of the devices is triggered when the child is placed in the child seat.

The device will periodically flash red and beep once to notify you the battery/batteries require replacement in that unit.

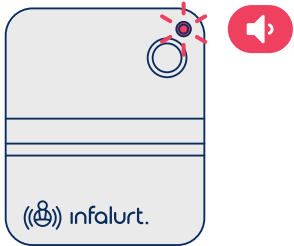

Changing Batteries

To change the battery, remove the screw from the back cover of the Child Seat Unit, Control Unit and Key Fob.

Install 2 x AA batteries in the Child Seat Unit and 2 x AA Batteries in the Control Unit. CR123 battery is to be installed in the Key Fob.

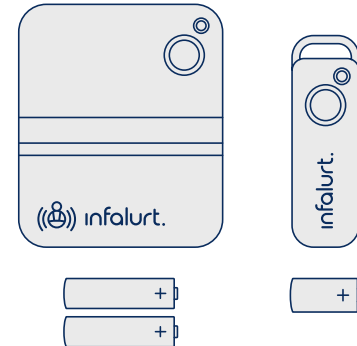

PLEASE NOTE

We recommend changing batteries in all Units and Key Fob within 12 months, prior to summer, and/or when notified by any Unit or Key Fob

Frequently Asked Questions

If your question is not addressed here,
feel free to email info@infalurt.com.au

Q: Can I add more than one child seat to Infalurt System?

A: Yes. You can add up to 4 Child Seat Units linked to the one Key Fob.

Q: How will I know when the batteries are going flat?

A: When a child has been placed into the child seat, the system will indicate which Unit / Key Fob needs its batteries replaced, by flashing red periodically and beeping once.

Q: How much time do I have before replacing batteries?

A: Replace immediately once you have been notified by the system.

Q: Where can I purchase replacement batteries?

A: Batteries can be purchased from any Supermarket or Hardware store.

Q: What type of batteries are required?

A: Control Unit and Child Seat Unit require 2 x AA batteries in each unit. The Key Fob requires 1 x CR123.

Q: What happens if the Key Fob doesn't flash blue when I place child in child seat.

A: Re-pair the system as per instructions Step 3a. to Step 3c. in Instruction Manual.

Q: Can I purchase a replacement Control Unit, Child Seat Unit and Sensor Pad, or Key Fob individually, if lost or damaged?

A: Yes. All of the items can be purchased separately.

Frequently Asked Questions

Q: Is there a possibility of electric shock from the Infalurt system.

A: No.

Q: There are 2 vehicles parked next to each other, both have the Infalurt System installed, will my Key Fob recognise my system?

A: Yes. Each system is paired to its own Key Fob.

Q: Can I transfer my Infalurt System from my vehicle to another vehicle?

A: Yes. The Infalurt System can be transferred to another vehicle, however the system will need to be re-calibrated. Refer Step 4 in Instruction Manual, Calibrating the System. We would recommend purchasing a separate Infalurt System for each vehicle for which your child is regularly transported, to ensure your child is always protected.

Q: Can I place the Control Unit anywhere inside the vehicle?

A: No. The Control Unit is best placed in the centre console.

Q: Can I use any of the Units or Key Fob for any other electronic devices?

A: No. The Infalurt System cannot be used for any other electronic devices.

Q: What colours are available for the Infalurt System?

A: The Infalurt System is only available in black.

Contact Us

If you'd like to get in touch with Infalurt, email us at info@infalurt.com.au or visit infalurt.com.au



@infalurt



infalurt.







infalurt.com.au